



E8
User manual

1 Instructions for use and product drawings

Dear user!

Thank you for using this smart lock. Before you install and use it, please check the list of accessories carefully. Please read the installation instructions and follow its steps, otherwise we will not be responsible for any hazards or damages.

△Important Notes Please read and set the function according to the specific product model.

1. Storage capacity: card, password, fingerprint three total 300 (Maximum fingerprint capacity of 100 sets), you do not need to distinguish the type.
2. When low battery alarm, please replace the same type of battery in time and pay attention to the positive and negative pole installation to ensure the normal use of the lock. (New and old batteries cannot be used at the same time)
3. Please keep the mechanical key with you when not in use and do not keep it in the house where the smart lock is installed. This mechanical key is emergency use.

Product figure

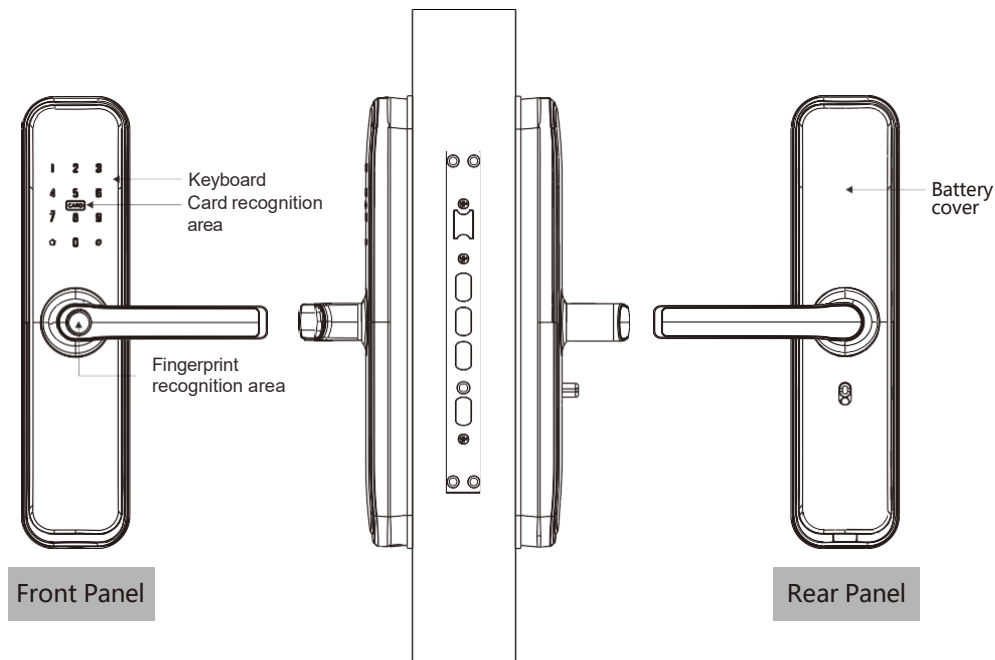

2 Product List / Installation Exploded Diagram

Please check carefully according to the following list after unpacking the package. If you find any missing, please contact us or the agent in time.

	Name	Quantity	For note
1	Outer panel (including silicone pad)	1	
2	Rear panel (including silicone pad)	1	
3	IC Card	2	
4	Installation Accessories Package	1	
5	User's manual	1	
6	Certification	1	
7	Product Quality Warranty Card	1	
8	Lock core package	1	Including Mechanical Key x2, Lock Core x1

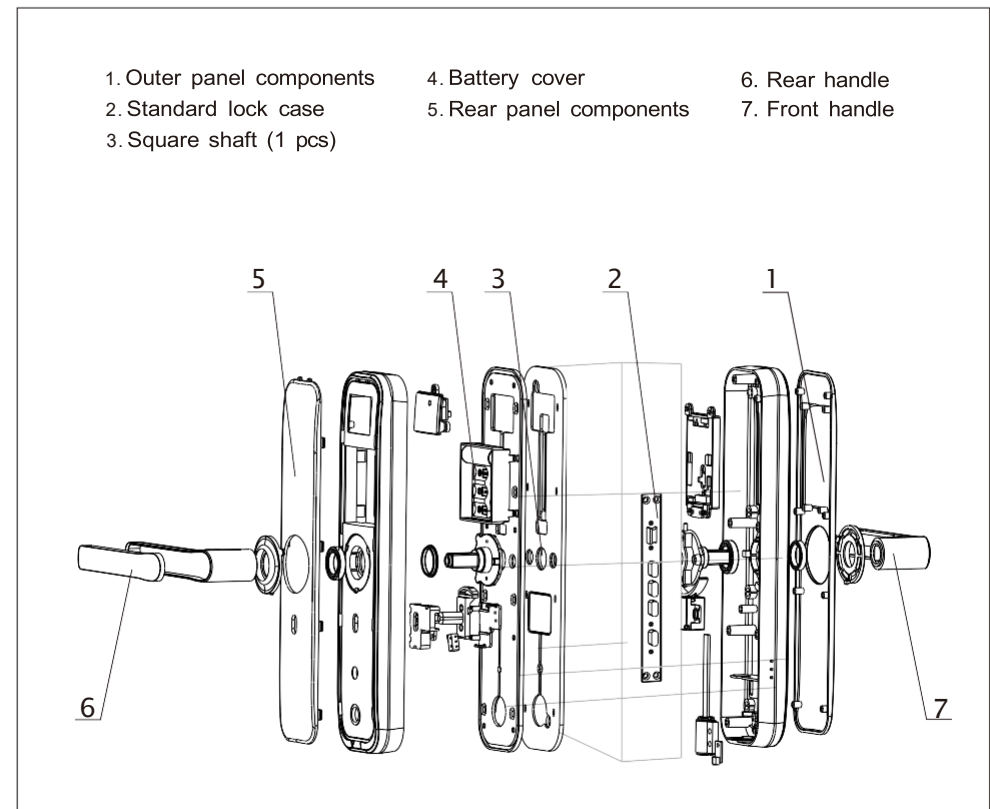

3 Notice Before Installation

3.1 Please confirm the type of opening door before installation. The smart lock can be applied to four types of open doors: left pull, left push, right pull, right push.

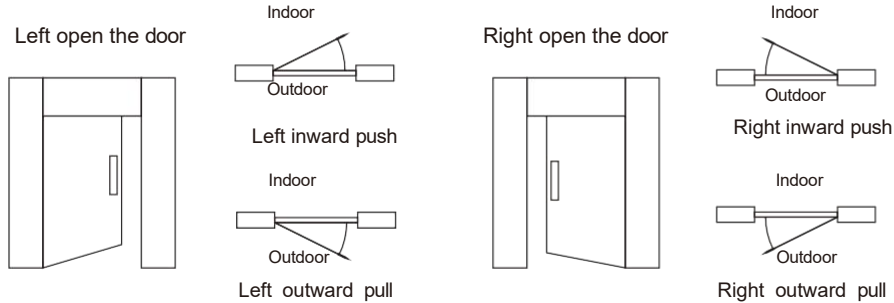

3.2 Turn the handle side to side. Please press the opening direction of the door to select the handle.

Steps:

1. Remove the pan head screws.
2. Rotate the handle to the desired direction.
3. Install the removed screws back.
4. When installing, the arrow is upward.

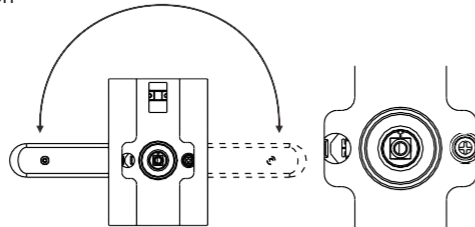

3.3 Lock body oblique tongue reversing. Change the direction of the slanted tongue

According to the requirements for opening doors both inside and outside, change the direction of the slanted tongue of the lock body

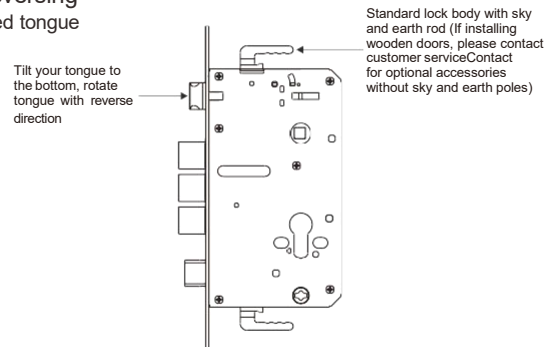

⚠ Pay attention

1. Select spare parts of different sizes according to the thickness of the door.
2. The spare parts pack with default factory configuration is suitable for 60~90mm doors thickness, if it is other specifications, please contact us.

4 Installation Steps

4.1 Open the holes on the door according to the template, and put the lock body into the door frame.

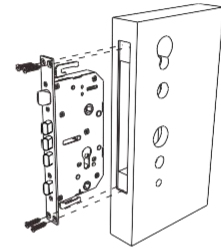

4.2 Tighten the four screws on the lock case.

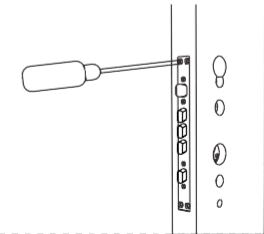

4.3 First, press the copper dots on the square rod, and the copper dots match. Insert the circular hole on the side of the clutch into the clutch. In the coupler, the copper point of the square rod automatically returns to its original position.

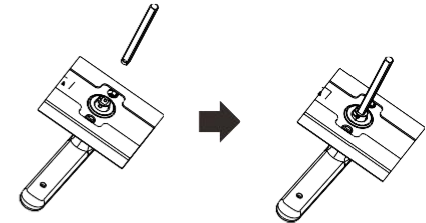

4.4 Pass the connecting wire through the crossing port above the door, and insert the square shaft on the outside plate into the square shaft port on the lock body, so that the outside plate is close to the outside of the door. Finally, the connecting line is connected to the rear panel jack, and the rear panel is attached to the door. The pull screw is aligned with the pull screw hole on the inner panel and tightened with the fixing screw.

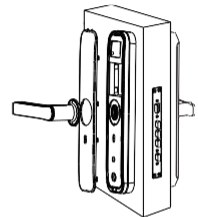

4.5 Install the battery, cover the decorative cover, and install the side gusset assembly before installing the smart lock. Press down and lift up the inner and outer handles and mechanical keys to check whether the components are properly connected.

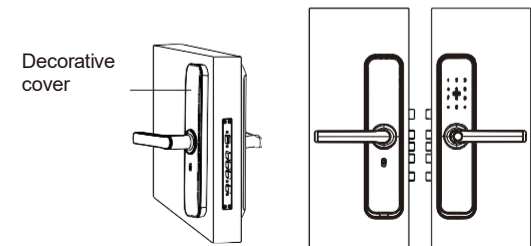

5 Installation Steps

Usage environment	Working temperature	-25~70°C
	Relative humidity	0%~93%RH No condensed water droplets
Consumption	Power supply mode	4 No. 5 dry batteries
	Working power supply	4.8V~6V±0.2V
	Working current	≤180mA
	Static power consumption	≤60uA
	Low voltage alarm	4.8V±0.1V
Fingerprint collection head 【There are differences in the selection of fingerprint heads based on actual conditions】	Compare speed	1:10<500ms 1:N<1s(N≤100)
	Comparison method	1:N
	Refusal rate(FRR)	<2%
	False recognition rate(FAR)	<0.001%
	Antistatic ability	Contact 8KV/air discharge 15KV
	Fingerprint	Semiconductor sensors
Number of users	Number of administrators	9 groups
	Number of users	300 groups (including administrator users)
storage capacity (300 sets of cards, passwords, and fingerprints in total, you do not need to distinguish the type.)	ID capacity	300 groups (maximum)
	Password capacity	300 groups (maximum)
	Fingerprint capacity	100 groups

6 Operating instructions

6.1 Function and Operation

6.1.1 Terminology and Function Key Description

- 1) Administrator Information: Refers to the administrator's fingerprint, password, or swipe card.
- 2) Unlock information: refers to the fingerprint, password, or IC card information entered (including administrators and regular users).
- 3) The "*" key is the clear/back key. When entering a password, press to clear the previous input, and press continuously 4 times to clear the input.
- 4) The "#" key is a confirmation key.

6.1.2 Initial state

- 1) In the initial state, any fingerprint, card swipe, or password can unlock the lock.
- 2) After entering the administrator information, fingerprints, cards, or passwords that have not been entered cannot be unlocked.

6.1.3 Enter the door lock function management

In the initial state, touch the number area, light up the screen, and press the "*" # key+123456 to enter the door lock function management menu. (The initial password for administrator management is "123456") Voice broadcast: Please press 1 for administrator settings, 2 for user settings, press 3 for Systems settings, and press 4 for factory reset.

6.1.4 Administrator settings

Please enter administrator information



Please press 1 for administrator settings
Please press 2 for user settings
Please press 3 for system settings
Please press 4 to restore factory settings

Note: During the input process, fingerprints need to be entered 5 times, passwords have to be 6 digits, and card swiping only requires one swipe; After the input is completed, press the "*" key to return to the previous menu or exit.

6 Operating instructions

1) Enter administrator information

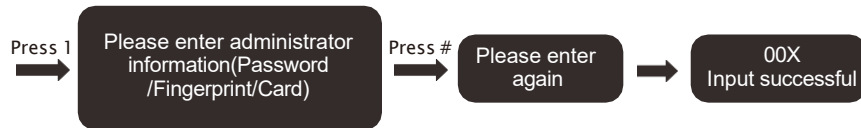
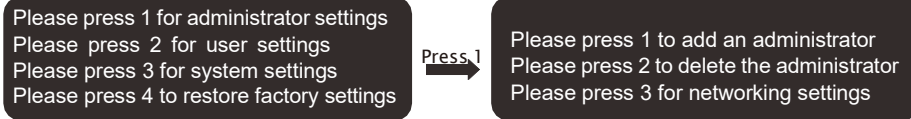

2) Delete administrator information

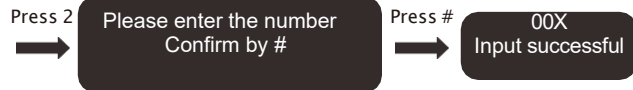
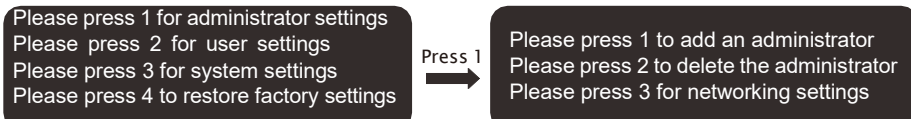

3) Networking settings

1 Hotspot connection

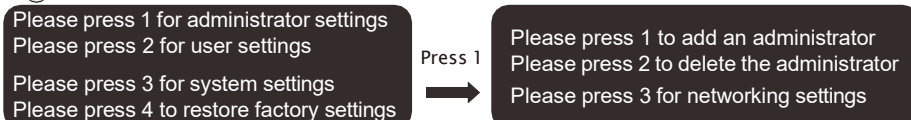

6 Operating instructions

2 Intelligent Connection

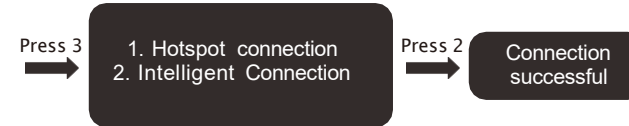

6.1.5 User Settings

1) Add user information

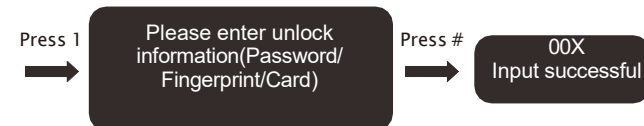

Note: During the input process, fingerprints need to be entered 5 times, passwords have 6 digits, and card swiping only requires one swipe; After the input is completed, Press the "*" key to return to the previous menu or exit

2) Delete User - Number Delete

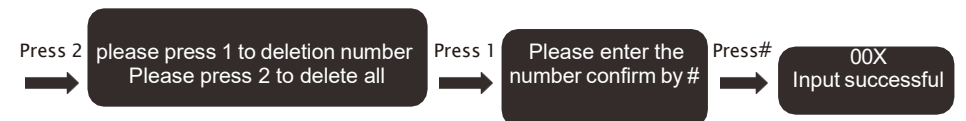
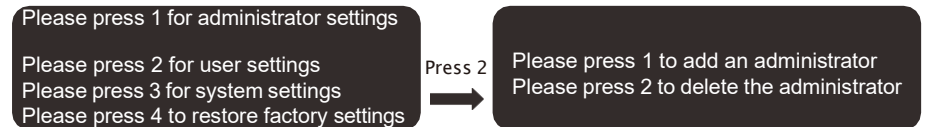

6 Operating instructions

3) Delete User - Delete All

Please press 1 for administrator settings
Please press 2 for user settings
Please press 3 for system settings
Please press 4 to restore factory settings

Press 2 → Please press 1 to add an administrator
Please press 2 to delete the administrator

Press 2 → please press 1 to deletion number
Please press 2 to delete all

Press 2 → Confirm by #

6.1.6 System settings

1) Voice settings

Voice On

Please press 1 for administrator settings
Please press 2 for user settings
Please press 3 for system settings
Please press 4 to restore factory settings

Press 3 → Please press 1 for voice settings
Please press 2 for unlock mode
Please press 3 for language selection
Please press 4 for time setting
Please press 5 for modify the room number

Press 1 → Please press 1 to open voice
Please press 2 to turn off voice

Press 1 → Operation successful

Voice Off

Please press 1 for administrator settings
Please press 2 for user settings
Please press 3 for system settings
Please press 4 to restore factory settings

Press 3 → Please press 1 for voice settings
Please press 2 for unlock mode
Please press 3 for language selection
Please press 4 for time setting
Please press 5 for modify the room number

Press 1 → Please press 1 to open voice
Please press 2 to turn off voice,

Press 2 → Voice off

6 Operating instructions

2) Unlock mode

Single unlocking

Please press 1 for administrator settings
Please press 2 for user settings
Please press 3 for system settings
Please press 4 to restore factory settings

Press 3 → Please press 1 for voice settings
Please press 2 for unlock mode
Please press 3 for language selection
Please press 4 for time setting
Please press 5 for modify the room number

Press 2 → Please press 1 for single unlock
Please press 2 for combination
unlocking

Press 1 → Operation successful

Combination unlocking

Please press 1 for administrator settings
Please press 2 for user settings
Please press 3 for system settings
Please press 4 to restore factory settings

Press 3 → Please press 1 for voice settings
Please press 2 for unlock mode
Please press 3 for language selection
Please press 4 for time setting
Please press 5 for modify the room number

Press 2 → Please press 1 for single unlock
Please press 2 for combination
unlocking

Press 2 → Operation successful

3) Language selection

Chinese mode

Please press 1 for administrator settings
Please press 2 for user settings
Please press 3 for system settings
Please press 4 to restore factory settings

Press 3 → Please press 1 for voice settings
Please press 2 for unlock mode
Please press 3 for language selection
Please press 4 for time setting
Please press 5 for modify the room number

Press 3 → Please press 1 for Chinese
Please press 2 for English

Press 1 → Operation successful

6 Operating instructions

4) Language selection English mode

Please press 1 for administrator settings
Please press 2 for user settings
Please press 3 for system settings
Please press 4 to restore factory settings

Press 3

Please press 1 for voice settings
Please press 2 for unlock mode
Please press 3 for language selection
Please press 4 for time setting
Please press 5 for modify the room number

Press 3

Please press 1 for Chinese
Please press 2 for English

Press 2

successful

5) Time setting

Please press 1 for administrator settings
Please press 2 for user settings
Please press 3 for system settings
Please press 4 to restore factory settings

Press 3

Please press 1 for voice settings
Please press 2 for unlock mode
Please press 3 for language selection
Please press 4 for time setting
Please press 5 for modify the room number

Press 4

Current time, 2019 November
11th at 11:00 am 11 points,
please modify

Press #

operation
successful

6) Room number modification (Not Applicable to Residential)

Please press 1 for administrator settings
Please press 2 for user settings
Please press 3 for system settings
Please press 4 to restore factory settings

Press 3

Please enter administrator
information

Press #

operation
successful

6 Operating instructions

6.2 Other instructions

1. If the wrong password / fingerprint / IC Card is entered for more than 5 times, the system will be locked, and will unlock after 90 seconds.
2. Privacy function: Entering the passcode to unlock as follow: *****password*****, you can enter random digits before the real passcode, and random digits after the real passcode, press # to confirm.
3. If no any next action within 10 seconds, the system will quit automatically, and the display will turn off.
4. If the voltage is lower than 4.8V when unlock, the smart lock will ring the alarm. After the low battery alarm has rang more than 200 times, the unlock function will delay for 5 seconds. Its recommended to change the battery before the "low battery" alarm exceeds 200 times.
5. Initialization setting: Long press for 6 seconds the reset button on the back panel (within the battery compartment), and the system will initialize automatically. All unlock information (password / fingerprint / IC card) will be deleted, and the system would require to set from fresh.

7 LK Smart APP Networking (Optional)

7.1 Download TUYA APP

Search for "LK Smart" in the Apple App Store or android market and download the App



7.2 Registered account

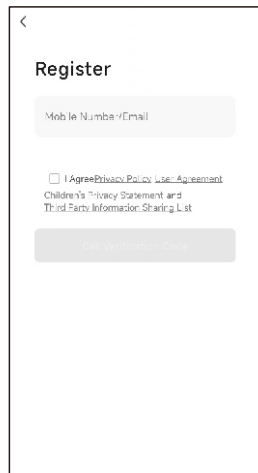
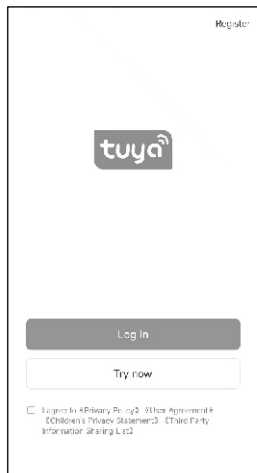

7 LK Smart APP Networking (Optional)

1. Click "Register", the privacy policy page of LK Smart platform will pop up. After reading and agreeing, the account registration page will be entered

2. You can register by email or mobile phone number. The country/region will follow the setting of the mobile phone system, or you can manually change the country/region (the country/region cannot be changed after the registration is completed). After entering your mobile phone number or email address, click obtain verification code.

3. After entering the received verification code, the page will jump to the password setting page. After setting the password according to the instructions below, click "Finish" to complete the registration (wifi and Bluetooth must be enabled during operation.)

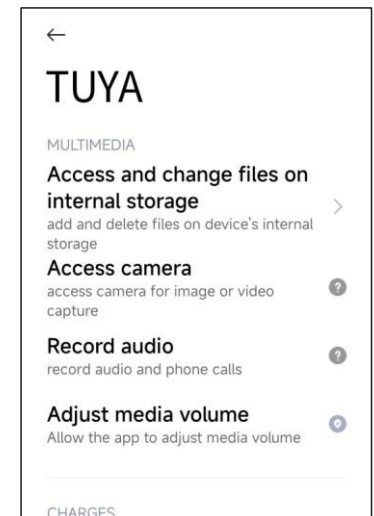
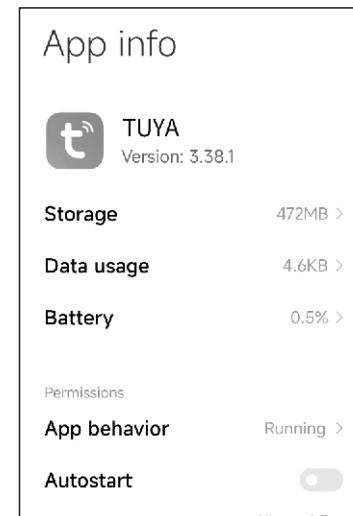

Open the application permissions, skip to the second image, permissions are all designed to allow

7 LK Smart App Networking (Optional)

7.3 Add equipment

Click "Camera & Lock" on the left to jump to Figure 3. Click "Smart Lock (Wi-Fi)". In Figure 4, select the Wi-Fi (2.4GHz) to connect the smart lock, and enter the Wi-Fi password. In Figure 5, ensure that the smart lock has been put into networking mode (Refer to Chapter 6, Step 3), and check the "Confirm the Indicator is blinking rapidly", before clicking Next.

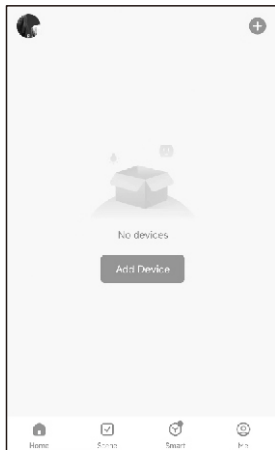

Figure 1



Figure 2



Figure 3

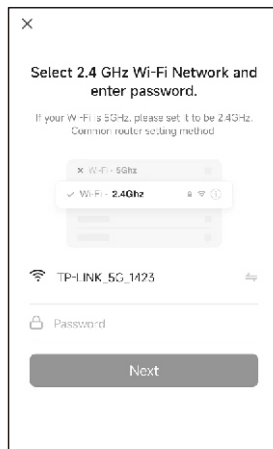

Figure 4



Figure 5

7 LK Smart App Networking (Optional)

The app will now search for the smart lock (Figure 6), ensure that the smart lock is already in networking mode (Refer to Chapter 6, Step 3), and wait for the smart lock to be added successfully (Figure 7). Ensure your mobile phone is located 10-20cm away from the lock.

Click on Finish to complete the process. Optionally, you may click on the Pencil icon to edit the name of the smart lock, and also the location where the smart lock is located.

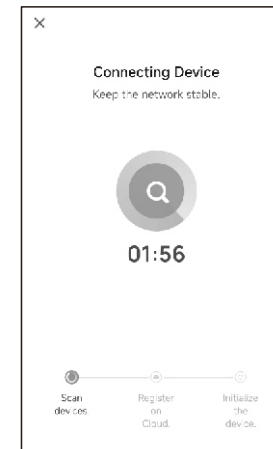

Figure 6

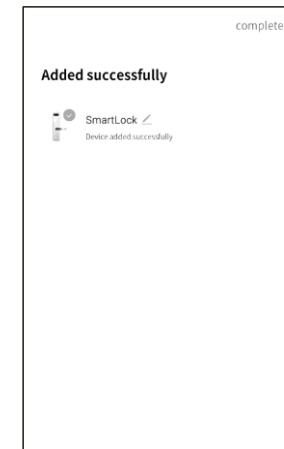

Figure 7

8 Warranty Card

1. One year free warranty since the date of purchase. If the warranty card and valid purchase certificate cannot be provided, or the purchase certificate has been tampered with, the warranty period shall start three months from the date of production of the airframe.

2. During the warranty period, under the condition of normal use according to the operation manual, the product defects (determined by the company's official staff); Repairs are made free of charge.

3. During the warranty period, the following conditions will not be repaired free of charge:

Artificial damage caused by improper use, such as improper parts, improper installation, failure to use in accordance with the instructions, misuse or negligence caused by damage, etc. Damage caused by transportation and other accidents. Repair and modification not approved by the company. Other damage caused by force majeure such as natural disaster, abnormal voltage, etc.).

Normal use of the product caused by aging, wear and tear, but does not affect the normal use of the product.

4. The appearance of the product is damaged by artificial scratches, fragile and on summable products and not within the scope of warranty, such as batteries.

Product model

Activation code

Dealer name

Purchase date

User name

Address of the user

Phone

Invoice no.

You phone